

HIGHWAY

Solar Module

HT60-156P

265W-280W

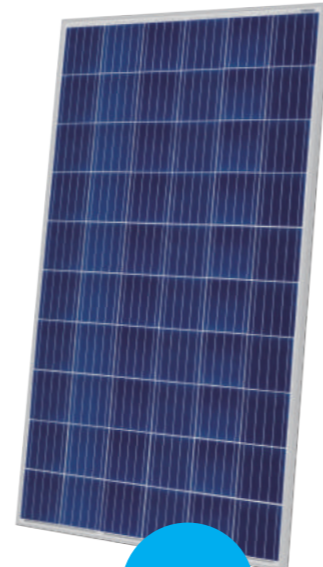

IEC IEC 61215 : 2016
IEC 61730 : 2016

+ 17.2%
Module Efficiency

⚡ Designed for high voltage systems of up to 1500 VDC, increasing the string length of solar systems and saving on BoS costs

🔍 Microcrack resistant
Triple EL tested of high quality control.

10_{Ys} Products Warranty

25_{Ys} Warranty on power output

P_{kw} Higher module's output power

ISO Strict quality control, meeting the highest international standards: ISO 9001, ISO14001 and OHSAS18001

2% All the modules are sorted and packaged by amperage, reducing mismatch losses and maximizing system output.



Electrical Characteristics

Module	HT60-156P			
Maximum Power at STC(Pmax)	265W	270W	275W	280W
Open-Circuit Voltage(Voc)	37.6V	37.9V	38.2V	38.5V
Short-Circuit Current(Isc)	9.28A	9.38A	9.47A	9.56A
Optimum Operating Voltage (Vmp)	30.5V	30.8V	31V	31.2V
Optimum Operating Current(Imp)	8.7A	8.78A	8.88A	8.98A
Module Efficiency	16.3%	16.6%	16.9%	17.2%
Maximum System Voltage	1000V DC(IEC)			
Maximum Series Fuse Rating	15A			
Operating Temperature	-40 °C to + 85 °C			

STC: Irradiance 1000W/m², module temperature 25, AM=1.5
Optional black frame or white frame module according to customer requirements

NOCT

Module	HT60-156P			
Maximum Power	194W	197.6W	201.3W	204.9W
Open Circuit Voltage (Voc)	35.3V	35.5V	35.8V	36.1V
Short Circuit Current (Isc)	7.5A	7.58A	7.66A	7.73A
Maximum Power Voltage (Vmp)	28.6V	28.9V	29.1V	29.3V
Maximum Circuit Current (Imp)	6.78A	6.84A	6.92A	7A
NOCT	45 °C ± 2 °C			

NOCT: Irradiance 800W/m², ambient temperature 20 °C, wind speed 1 m/s

Mechanical Characteristics

Solar Cells	Polycrystalline 156.75 × 156.75mm
No. of Cells	60 (6 × 10)
Dimensions	1640mm×992mm×35mm(64.6×39×1.4in)
Weight	19kg(41.9lbs)
Front Glass	High transmission tempered glass
Frame	Anodized aluminium alloy
Junction Box	IP67
Cable	4mm ² (IEC)
Connectors	PV-HT002-1
Packaging Configuration	30pcs/box, 840pcs/40'HQ Container

Temperature Characteristics

Temperature Coefficient of Pmax	γ (Pm)	-0.43%/K
Temperature Coefficient of Voc	β (Voc)	-0.31%/K
Temperature Coefficient of Isc	α (Isc)	0.053%/K

Warranty

10-year product warranty	
25-year warranty on power output	
Specific information is referred to the product quality guarantee	

Information Box

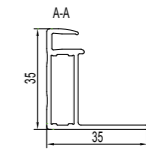
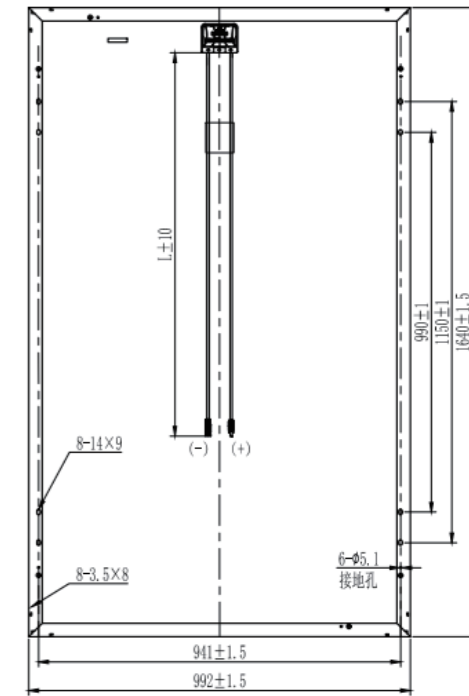

Current-Voltage & Power-Voltage Curve

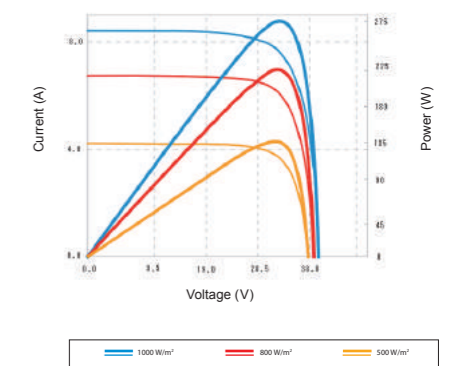

I-V Curves

Shanghai Aerospace Automobile Electromechanical Co., Ltd.
website: www.ht-saae.com

Factory: Lianyungang ShenZhou New Energy Co., Ltd.